

- Type:** Compression
Material: Stainless Steel
Protection: IP 68
Features: High Accuracy
 Four Columns Construction
Application: Weighbridge Road
 Weighbridge Rail
 Truck & Silo Scales
 Hopper Weigher



Specifications:

Capacity	t	10 / 25 / 40 / 60 / 100 / 225 / 450
Accuracy Class		C3
Max. Number of Verification Intervals	n_{max}	3000
Minimum Load cell Verification Interval	V_{min}	E _{max} /7500
Temperature Effect on Zero	%FS/10°C	≤ ± 0.0175
Temperature Effect on Sensitivity	%FS/10°C	≤ ± 0.0120
Combined Error	%FS	≤ ± 0.0200
Creep	%FS	≤ ± 0.0168
Output Sensitivity	mv/v	2.0 ± 0.002
Input Resistance	Ω	450 ± 4.5
Output Resistance	Ω	480 ± 5
Insulation Resistance	MΩ	≥ 5000
Zero Balance	%FS	1.0
Temperature, Compensated	°C	-10 ~ +40
Temperature, Operating	°C	-40 ~ +80
Excitation, Recommended	v	5 ~ 12(DC)
Safe Overload	%FS	150
Ultimate Overload	%FS	300
Standard Cable Length	m	10 (10t) , 20 (25t ~ 100t)

Dimensions:

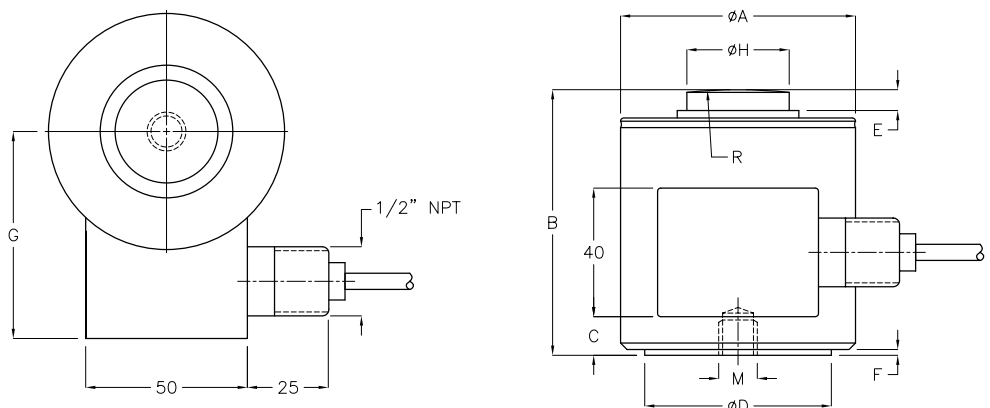
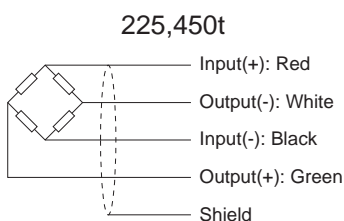
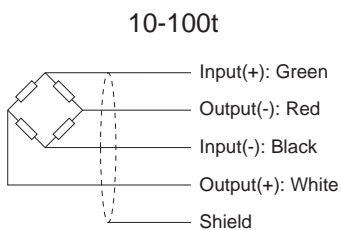

CAP.(t)	A	B	C	D	E	F	G	H	M	R
10,25	73.0	82.5	12.0	58	6.5	1.8	64.0	31.8	M12x1.75(11 Deep)	152.0
40,60	105.0	127.0	34.0	82.5	8.0	11.0	87.0	58.7	M20x2.5(20 Deep)	152.0
100	152.4	184.2	72.3	123.8	23.6	21.8	108.2	79.2	M20x2.5(20 Deep)	432.0
225	164.0	229.0	72.3	148.0	26.0	21.8	108.0	93.7	M20x1.5(25 Deep)	400.0
450	177.0	304.5	97.0	165.1	26.0	21.8	115.0	139.7	M20x1.5(32 Deep)	1143

All dimensions: mm.